

## FI1500 Flange Facing Machine

320-1500mm(12.6"-60")

YouTube

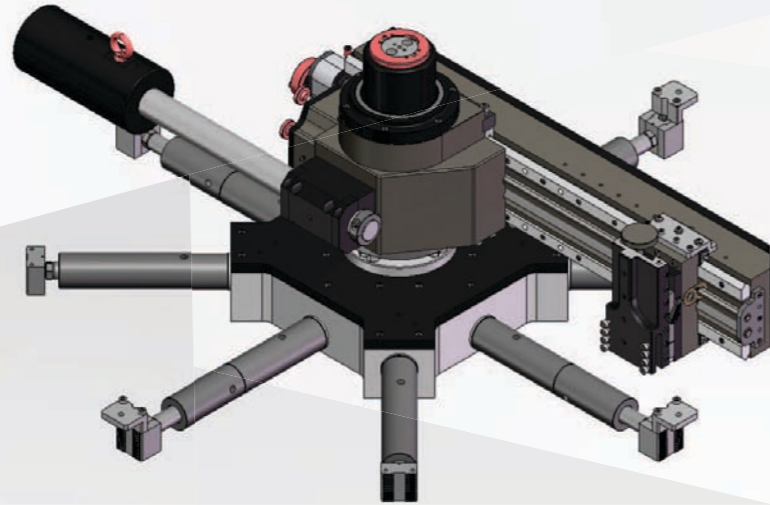

FI1500 is an ID mounted and robust flange facing machine capable of producing 6 different continuous groove gramophone finishes to ASME Standard. It has a working range of 320mm (12.6") to 1500mm (60"). The mounting bases come in three sizes and have micro-adjustable jaws to help quickly align the base during set-up. Air motor and servo motor are optional. It can machining standard FF and RF flange facing, RTJ and other V grooves, welding reparations, etc. The FI1500 Flange Facer are suitable for the oil and gas industry, power plants, chemical plants, offshore and many others.

### Features

- Modular designed, compact and portable
- High precision NSK bearings and V linear guide make the machine precise and robust
- ID Mounted and operates in any direction
- Light weight & Rigidity body 7075 Alu
- Suitable for various flange type: flat face, raise face, ring type joints(RTJ), Tongue & groove, compact flanges
- MODEC air motor and Panasonic electric servo motor drive for option
- 6 continuous groove facing feeds for a gramophone finish (ASME Standard)
- 6 boring auto-feed setting
- 3 different sized quick set independent bases for improved on-site operation
- 360° swivel tool post for groove details
- Steel case package, easy to storage and move

### Specifications

Model	FI1500P	FI1500E
Driven	Pneumatic	Electric - Servo
Motor	MODEC Air Motor	Panasonic Servo Motor
Power Supply	3m <sup>3</sup> /min (105CFM)@0.6Mpa (90psi)	380-415V 3PH 50/60HZ
Motor Power	4 HP	3000 W
Min. Facing Dia.	320mm /12.6"	
Max. Facing Dia.	1500mm / 60"	
Min. Clamping Dia.	290mm / 11.4"	
Max. Clamping Dia.	1450mm /57"	
Tool Post Travel	102mm /4"	
No. of Feed Settings	6	
Max. R.P.M	39	42
Machine Weight	220 Kgs (W/o base)	230 Kgs (W/o base)
Shipping Weight	660 Kgs	699 Kgs
Package	Steel Case	Steel Case
Shipping Dimensions	1480*725*900mm	1480*725*1060mm

Facing Feed Rates & Grooves per Inch				
Direction	Gear	mm/rev.	Inches/rev.	Grooves/Inch
In	1	0.1935	0.0076	131
In	2	0.3113	0.0123	82
In	3	0.6718	0.0264	38
Out	1	0.1430	0.0056	178
Out	2	0.2300	0.0091	110
Out	3	0.4964	0.0195	51

Boring Feed Rates			
3 off up/down	Gear	mm/rev.	Inches/rev.
In	1	0.0538	0.0021
In	2	0.0865	0.0034
In	3	0.1866	0.0073
Out	1	0.0397	0.0016
Out	2	0.0639	0.0025
Out	3	0.1379	0.0054

### Dimension Figure

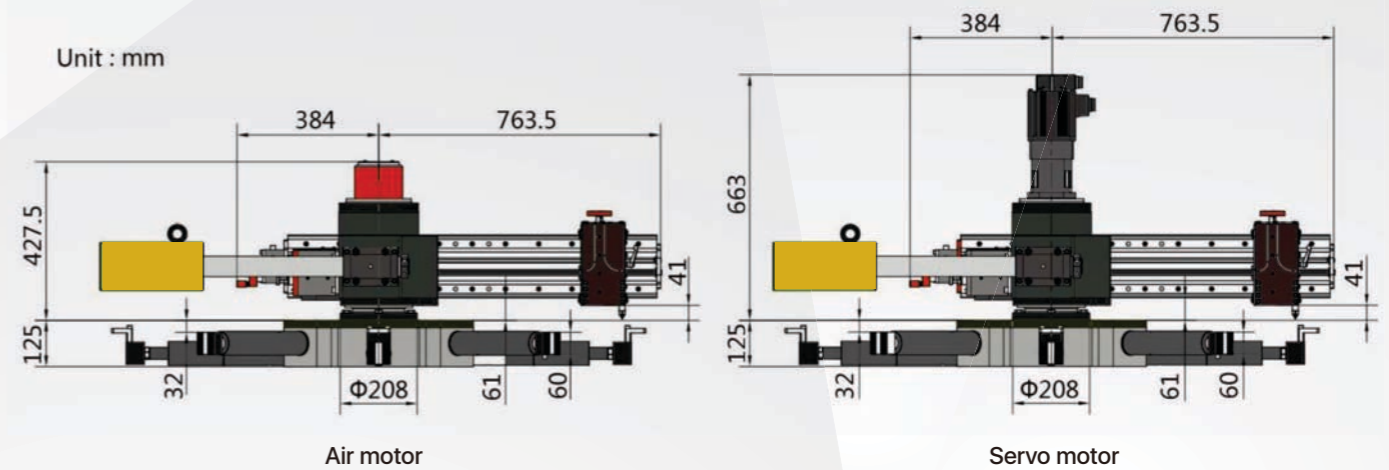

### 3 sized quick set independent bases for improved on-site operation View of the 3 bases assemblies provided

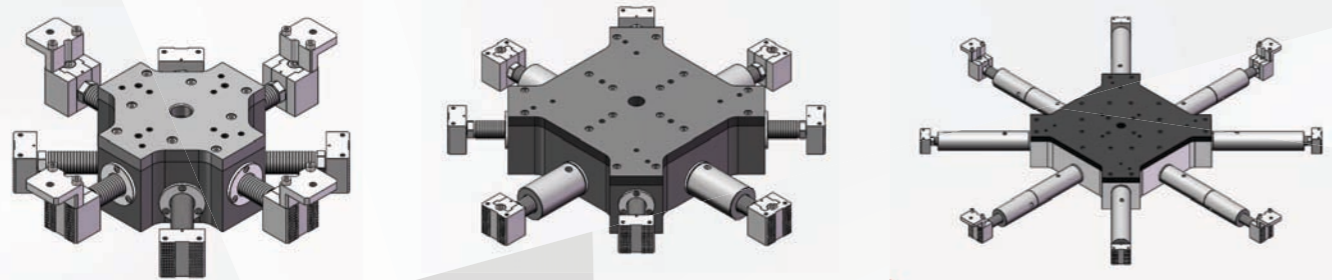

### Standard Supply

Main Body-c/w Motor	Full set Clamping Screws
S- Base	Full set extensions
M-Base	Full set hand tool
L-Base	Air motor lubricating oil
Tool Post	Air Filter Lubricator-SMC
Extension Tool holder	Hose connection
Cutting tips - 5 pcs	Dia Gauge
Counterweight	Storage / Shipping case
Counterweight plate	Manual
Extension nut	

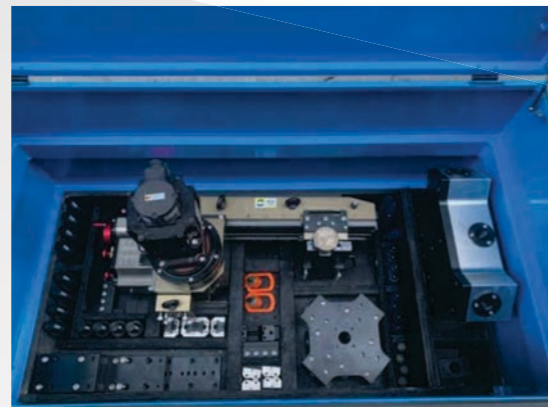

### Heat Exchanger Accessories

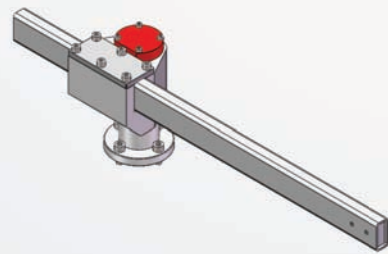

**Turing Tool**

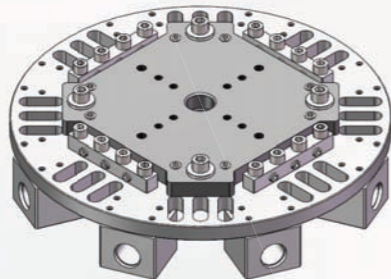

**Mounting Plate**

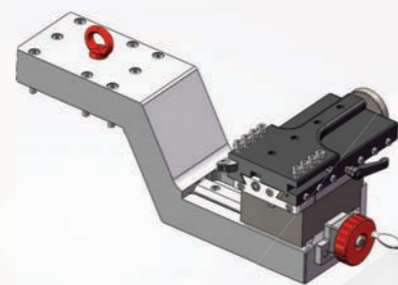

**Back facing tool holder**

### Configuration

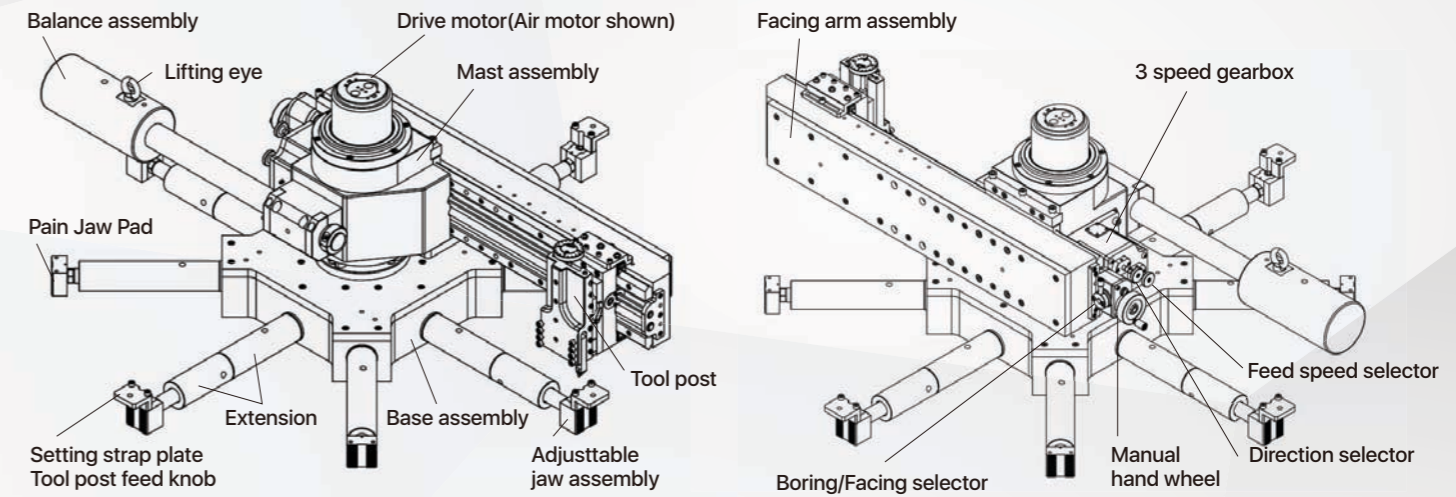

### Application

